

Link Ledger

Link Construction Group
20th Anniversary Edition - 2021

YOUR LINK TO BUILDING A STRONGER FUTURE



WWW.LINKCONSTRUCTIONGROUP.NET | 5350 NW 77 COURT | DORAL, FL 33166 | 305.665.9826

Thank you...

We are honored, humbled, and grateful to celebrate twenty successful years as a family and attribute our accomplishments to the collaborative efforts, commitment, hard work, dedication, and sacrifice of all involved along the way.

We offer a sincere thank you to our team members, clients, and associates who have been part of "Team Link" over the past twenty years and with whom we will continue to be the leaders of South Florida's Top Builders. We confidently look forward to another twenty-years of continued success, fruitful partnerships, and enduring and creative builds.

With great appreciation, we thank you for being part of our twenty-year journey which has provided hard-earned success and a lifetime of achievements to come.



Guillermo "Willy" Fernandez
President



Miguel "Mickey" Cerra
Executive Vice President

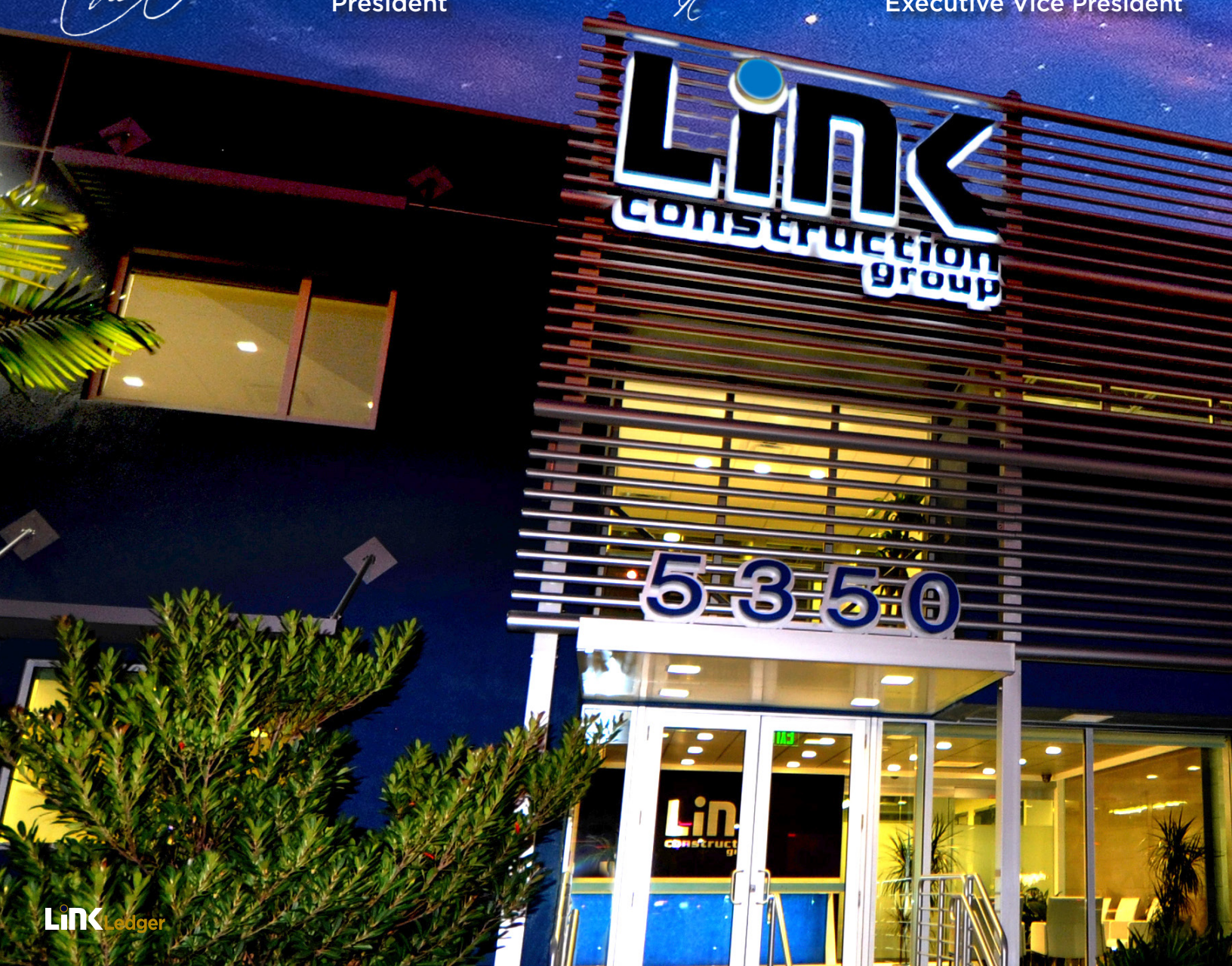

Link Ledger

20th Anniversary Edition - 2021

CELEBRATING 20 YEARS OF SUCCESS
REFLECTING BACK THROUGH THE YEARS

CONTENTS

2	PRINCIPALS' MESSAGE
4	COMPLETED PROJECTS
8	CURRENT PROJECTS
12	CELEBRATING 20 YEARS OF SUCCESS
14	EMPLOYEE EVENTS
15	AWARDS & ACCOLADES



WWW.LINKCONSTRUCTIONGROUP.NET

5350 NW 77 COURT
DORAL, FL 33166
TEL: 305.665.9826
FAX: 305.665.9851

Featured Completed **PROJECTS**

SUPERBLUE MIAMI

MIAMI, FL

Superblue Miami is a high-powered, immersive, and experiential art center which integrates the viewer as a participant of the artwork and immerses them into installations of light, video, sound experiences and journeys. It is a multi-sensory adventure where at times it surrounds you in a 360-degree world of art. The project was a collaborative effort, for Zubatkin Owner Representation, LLC, with consultants and artists from around the world that concentrated their attention on an existing one-story warehouse building in Miami where three world-renowned artists would construct Superblue's inaugural exhibits:

- **ES Devlin's "Forest of Us"** is inspired by bronchi in the lungs, limbs of trees, and rivulets into streams, which creates an interactive insight to her "theatrical design" incorporating optical-glass mirrors used to create a winding hedge maze leading visitors through a "reflective" affair.
- **teamLAB's "Proliferating Immense Life, A Whole Year per Year"** is an interactive digital display that has flower buds growing high and dying off once a spectator's touch is recognized. "Massless Clouds Between Sculpture and Life" is another teamLAB display which generates soap bubble clouds and dissolve as the visitors walk through the exhibit.
- **James Turrell's "Ganzfeld"** is a sensory experience which projects light onto a smooth blank wall, consuming the space with color, representing mood and emotion.

Architect: Kobi Karp Architecture & Interior Design, Inc.

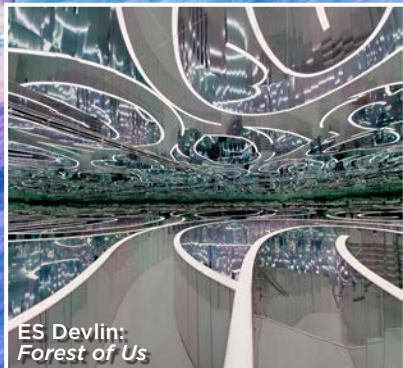



COSTEX TRACTOR PARTS HEADQUARTERS

MIAMI, FL



Completed in October 2020, Costex Tractor Parts unified their operations into one headquarter building consisting of a three-story office component attached to a two-story warehouse facility, which houses a solar power farm on the roof generating up to 2-megawatts of power. This allows the facility to run solely on solar power at certain times of the day, maximizing electrical savings and environmental benefits due to reduced power consumption. The office interiors, finishes, and details are expressive of Costex's diligence to quality, their clients, and the products they produce. The 454,887 SF headquarters building was designed as a symbol to the founder's years of dedication, hard work, and commitment.

Architect: Gustavo J. Ramos Architect

CORAL GABLES FIRE STATION NO. 2 & TROLLEY MAINTENANCE FACILITY

CORAL GABLES, FL

A remodel and addition to an iconic fire station and a new trolley maintenance building were the focus of this Coral Gables Design-Build project, situated between Miami-Dade County's Metrorail Line, US-1, a 24-hour active fire station, a 24-hour active fueling station, and FPL high-powered transmission lines. The project logistics were further complicated by the coordination of the multiple city and county agencies abutting the property and claiming construction and access limitations. This long endeavor produced a product which sits tall, proud, and visible to all who travel along US-1 and overhead along the Metrorail corridor.

Architect: Silva Architects

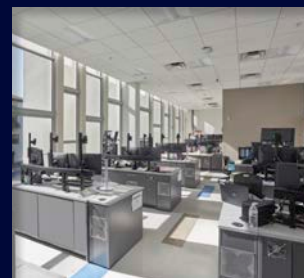

Featured Completed PROJECTS

PROLOGIS BEACON LAKES 36 E-COMMERCE FACILITY

MIAMI, FL

Prologis' Beacon Lakes Building 36 was transformed into a state-of-the-art mass logistics center with 4,300 parking stations for the client's employees and logistic fleet including Electrical Vehicle infrastructure to serve space for 1,600 future vehicles. The project was a seven-month fast-tracked effort alongside the client, Prologis, the design team, consultants, and the subcontractors who were entrusted to perform the tasks. The 203,000 SF mega-complex is set to be the hub of the South Florida E-Commerce market.

Architect: RLC Architects

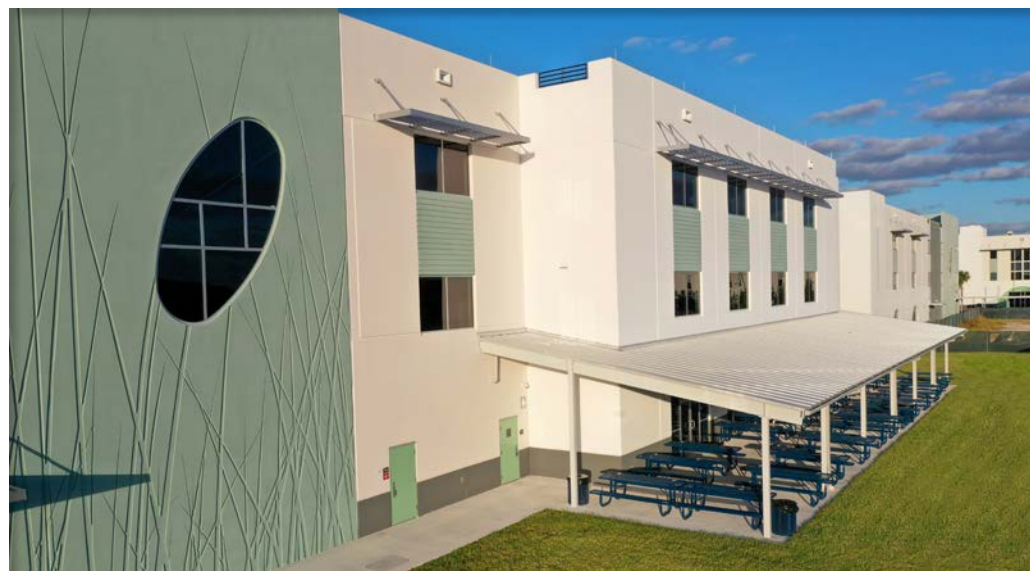

PINECREST GLADES ACADEMY PHASE III

MIAMI, FL

Link Construction Group completed this successful fast-track build for Academica as the third building of Pinecrest Glades Academy. Construction was performed on an active charter school campus consisting of classrooms, computer labs, art rooms, law and drama rooms, lunchroom, support areas, and an outdoor seating area to promote fresh air for students and faculty. The project adds to the student campus life and leaves it ready for its next expanse.

Architect: CIVICA Architecture

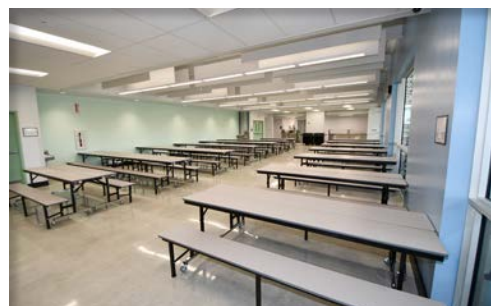



iAERO THRUST TEST CELL FACILITY

MEDLEY, FL

iAero Thrust is a uniquely designed building with a blast-proof jet engine testing enclosure which was a collaborative effort with the owner and their specialty consultants. Months of budgets, design meetings, and coordination between the owner's team, Link Construction Group, and our subcontractors paved the way to this facility's fruition. The building is a high-tech facility which tests jet engines, ensuring our airlines are kept safe.

Architect: Pereira Architects, P.A.



RUTH K. BROAD BAY HARBOR K-8 CENTER MIAMI, FL

This project was a classroom addition to Bay Harbor's Ruth K. Broad K-8 Center, complimenting the surrounding area which features a concentrated collection of Miami's mid-century building designs. The school has a basketball court on the ground floor, classrooms on its two elevated floors, a connection canopy to the existing school buildings, and supporting space for physical activity to promote a healthy social and learning environment. In dedicating the ground floor for outdoor activities, the second and third floor is efficiently used to create comfortable classroom and administrative areas for staff and students. The exteriors and interiors are filled with a lively color pallet stimulating learning and creativity.

Architect: Gurri Matute

Featured Completed PROJECTS

PROLOGIS MIAMI HEADQUARTERS

DORAL, FL

Link Construction Group was proud to work with Prologis on their Miami headquarters at the Beacon Centre. The office space was transformed with a fresh and innovative look, creating a harmonious and productive workspace for staff and a welcoming atmosphere for visitors. Work performed included a complete office make-over and a new conference room featuring a folding door partition, which opens to create a seamless flow from the meeting room into the break room. Multiple meeting rooms were included in the design to ensure privacy and proper workspace for the Prologis team members, as Miami's largest industrial developers. Link Construction Group thanks Prologis for the continued partnerships and for entrusting us to successfully deliver quality builds alongside our teams.

Office Architect: TSAO Design Group

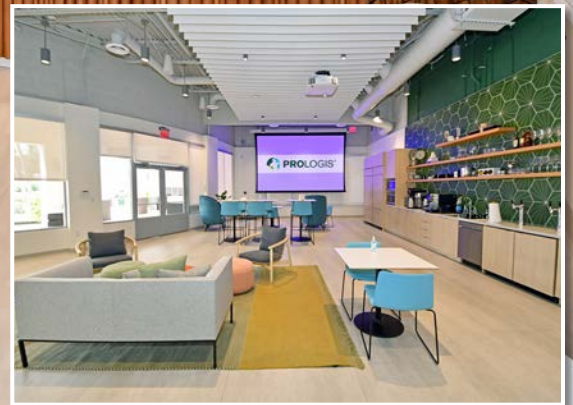

MEGACENTER MIRAMAR INDUSTRIAL PARK - PHASE II

MIRAMAR, FL

Link Construction Group returned to Megacenter Miramar to continue with Phase II of the master plan, completing the overall five-building remodel, addition, and new construction project, consisting of over 330,000 SF of available commerce space. Link's partnership with Megacenter commenced in 2017, with Phase I, and has now completed the vision that started over five years ago. The 15-acre complex contains a mixture of business types, from warehouse and office spaces to storage and manufacturing businesses. The LEED Certified project has a Spanish Flavor architecture reminiscent of the City of Miramar's planning requirements.

Architect: Cartaya and Associates Architects, P.A.



Featured Current **PROJECTS**



MATER BRICKELL PREPARATORY ACADEMY

MIAMI, FL



In March 2021, Link Construction Group broke ground on Academica's new City of Miami Charter School. Mater Brickell Preparatory Academy is a seven-story high school with a basement projected to open for the 2022-2023 school year, housing 1,500 students and 90 faculty and staff members. The new high school is a much-awaited addition to the Downtown/Brickell residential neighborhoods providing an elevated education alternative. The school is equipped with administrative offices, classrooms, laboratories, a parking garage, cafeteria, kitchen, and a gymnasium on the sixth floor. This project will be a challenging endeavor due to it being located in a dense residential area, up against I-95, a resident apartment building, a multi-story hotel, and requiring an extensive dewatering process. As Academica's largest build to date, Mater Brickell Preparatory Academy will be an honorable addition to the Charter School division.

Architect: CIVICA Architecture

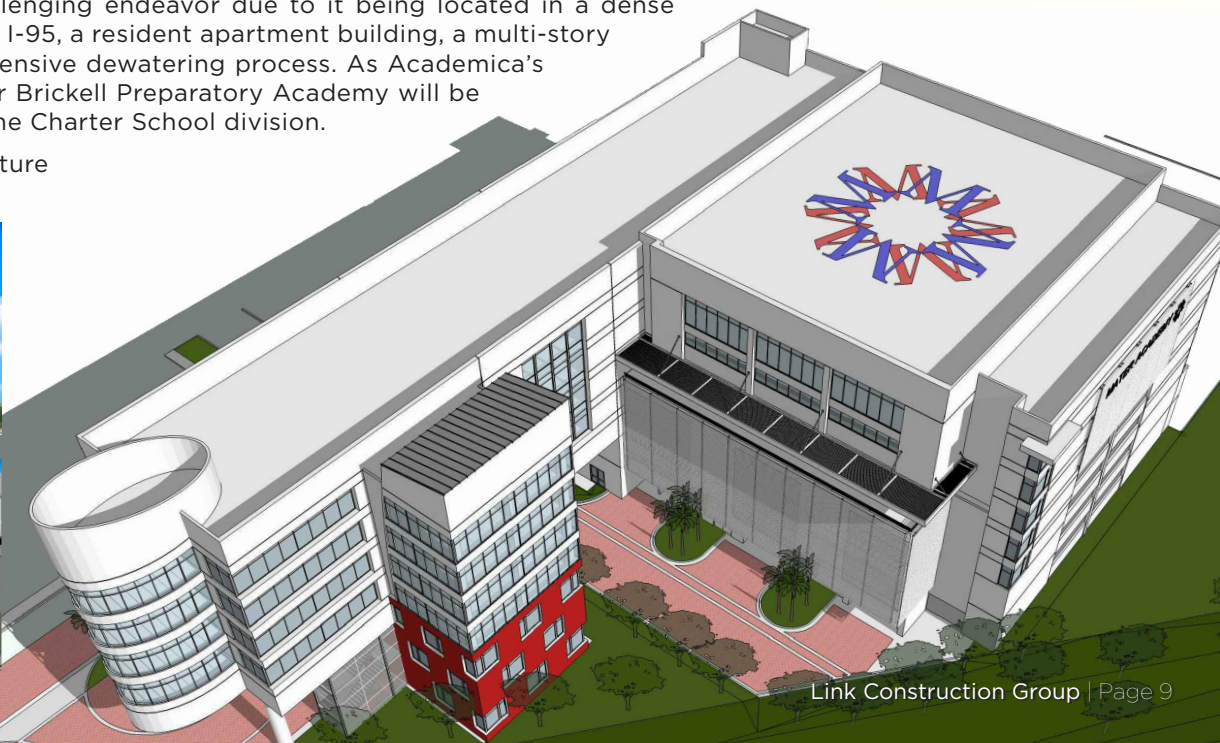



ST. THOMAS UNIVERSITY - PHASE II DORMITORY & DINING HALL

MIAMI GARDENS, FL

Link Construction Group has once again partnered with University Housing Solutions and returned to the St. Thomas University Campus for construction of a new four-story student dormitory and two-story dining hall. The dormitory adds housing for 306 students to an internationally expanding campus while the dining hall will provide dining and serving facilities on the ground floor and social and meeting areas on the second floor. The buildings are united by a common plaza providing the students an area to congregate contributing to the campus lifestyle. This project is part of the university's growth plan expanding its world-wide enrollment.

Architect: MKC Architect



CITY OF MIAMI GARDENS SENIOR FAMILY CENTER

MIAMI GARDENS, FL

The City of Miami Gardens is excited to open its doors to their new Senior Family Center early this Summer. The City's senior population lobbied the State of Florida and acquired the bond funds to design and construct this facility serving the Miami Gardens community. The center invites its residents to stroll around the existing community gardens and utilize the new fitness room, meeting rooms, outdoor patio, and pavilion. The outdoor patio and pavilion are designed to showcase community events and functions while the indoor multipurpose rooms can be used for informal and formal functions, supported by a warming kitchen. Link Construction Group is honored to have been part of this journey to provide a gathering place for the City of Miami Gardens community.

Architect: Silva Architects





BONAVENTURE FIRE RESCUE STATION NO. 21

WESTON, FL

The City of Weston's Bonaventure Fire Rescue Station No. 21 is a new fire station designed to withstand a category five hurricane and operate 24-hours a day, seven-days a week, with or without local electrical service, due to the emergency generator sized to run the entire facility. With all modern-day features, the fire station will be completed with three apparatus bays and an air boat storage to serve the community.

Architect: Saltz Michelson Architects

HIALEAH GARDENS TRADE CENTER

HIALEAH GARDENS, FL

The Hialeah Gardens Trade Center Building 'A' will be a 180,650 SF warehouse building in a heavily active industrial neighborhood. The existing soil conditions require a large process eliminating the organics to make it structurally sound to support the new building. The shell building will lend itself as flexible space for future tenants looking to capitalize in Hialeah Gardens' logistical hub. Link Construction Group is working diligently for this Cadence Partners build, slated for completion for the first quarter of 2022.

Architect: AR Architecture, LLC





Link

construction group

CELEBRATING REFLECTING

APR 2001



Link Construction Group Established on April 16, 2001

MAR 2003



Link Construction Group moves into 2nd office in Marina Lakes

JUN 2006



Link Construction Group moves into 3rd office on N. Waterway Drive

MAR 2007



Starts 1st LEED Certified project Staples - LEED Gold

NOV 2008



1st multi-story project completed. Causeway Square

NOV 2013



Historic landmark, Hialeah Park Racing & Casino, restored and expanded

With a big dream and a small beginning, Guillermo "Willy" Fernandez and Miguel "Mickey" Cerra took a chance on their shared vision in building a construction company set apart from the rest. In 2001, Willy and Mickey invested \$500 each towards the incorporation of Link Construction Group. Hard work and dedication contributed to the development of working relationships, which created a firm foundation for Link to prosper. The growth and success of the company led them to establish Link's official state-of-the-art headquarters in Doral, Florida, where their continued evolution would be limitless. Over the past twenty years, Link Construction Group has developed a culture for opportunity and growth. Mickey and Willy are humbled and proud to lead a team who manage some of the best work in the construction industry. Mickey, Executive Vice President, credits Link's success by expressing, "We've worked hard throughout the years



CELEBRATING 20 YEARS OF SUCCESS LOOKING BACK THROUGH THE YEARS

DEC 2014



Introduction of New Link Logo

JUL 2015



Link Construction Group opens official headquarters in Doral, FL

MAY 2017



Link ranks #1 for South Florida Business Journal Best Places to Work

MAY 2018



Completion of five million square feet of industrial construction

MAR 2020



Link Construction perseveres as an Essential Business during COVID-19

APR 2021



Link celebrates twenty years in business

to develop an internal practice which unifies key employees with intentional responsibilities where communication, organization, and collaboration flow in a synchronized manner. This produces dependability, transparency, and accountability for each of our projects. Our team principals establish consistency within each department serving to benefit each of our clients.” Willy, President of Link, shares his heartfelt thoughts by saying “I take great pride in the reputation our company has attained. The relationships we’ve established with our clients, associates, and members of our community have provided a reputation that is second to none. Above all, I am most proud of our team and their extraordinary work ethic which has helped us continue our success in the construction sector. Together, we are what makes Link Construction Group go above and beyond for our clients in building a stronger future.”

LINK CONSTRUCTION GROUP

EVENT PHOTOS



Costex Topping Out Party



Pinecrest Glades Academy
Caja China Challenge



Habitat for Humanity
Blitz Build



FIU Student Chapter
Golf Tournament



FIU School of Construction
Spring Expo



Coral Gables Fire Station 21
Top Off Party



PPE Mask Donation
at Memorial West Hospital



Superblue Project
City of Miami Mayor Site Visit



Coral Gables Fire Station
Ribbon Cutting



Link Wears Pink



Halloween Office Breakfast



Office Hair Cut Day



Costex Contractor
Appreciation Day



Linksgiving Luncheon



Ugly Sweater Day
Toy Drive for Kids



End of the Year Office Party

Awards & Accolades



**SOUTH FLORIDA
BUSINESS JOURNAL**

- TOP GENERAL CONTRACTORS & CONSTRUCTION COMPANIES - RANKED #13
- BEST PLACE TO WORK - RANKED #6



EXCELLENCE IN CONSTRUCTION AWARDS

PYRAMID AWARD WINNER
COSTEX TRACTOR PARTS
NEW HEADQUARTERS



EAGLE AWARD WINNER
CORAL GABLES FIRE STATION NO. 2
& TROLLEY MAINTENANCE BUILDING



WELCOME New Link Hirees



ANTHONY BONET
ESTIMATOR



CARINA CORTES
ASSISTANT PROJECT
MANAGER



OMAR LOPEZ
SENIOR PROJECT MANAGER



PHILLIP STANDEN
ASSISTANT PROJECT
MANAGER



TERRY FULTON
PROJECT MANAGER



5350 NW 77 COURT | DORAL, FL 33166
TEL: 305.665.9826 | FAX: 305.665.9851



WWW.LINKCONSTRUCTIONGROUP.NET

LinkLedger

YOUR LINK TO BUILDING A STRONGER FUTURE

Guillermo Fernandez, President and Miguel Cerra, Executive Vice President, incorporated Link Construction Group on April 16, 2001. Since its inception, Link Construction Group has been providing superior services in all segments of the construction market including Healthcare, Retail, Commercial, Industrial, Educational, Public, Financial, Parks, Gaming, Low-Income Housing Communities and Multi-Family Developments. Their extensive experience and unparalleled work ethic has propelled Link's growth and status in the South Florida construction marketplace.



Miguel "Mickey" Cerra
Executive Vice President

Guillermo "Willy" Fernandez
President

